

THIS DRAWING IS THE PROPERTY OF SPENCE & ASSOCIATES DESIGN CONSULTANTS AND IS NOT TO BE REPRODUCED OR TRANSMITTED IN ANY FORM OR BY ANY MEANS, ELECTRONIC OR MECHANICAL, INCLUDING PHOTOCOPYING, RECORDING, OR BY ANY INFORMATION STORAGE AND RETRIEVAL SYSTEM. THE CONTRACTOR MUST VERIFY ALL DIMENSIONS AND REPORT ANY DISCREPANCIES TO THE DESIGNER BEFORE PROCEEDING WITH THE WORK. THE WORK SHALL BE APPROVED BY SPENCE & ASSOCIATES UNDER NO CIRCUMSTANCES SHALL THE CONTRACTOR PROCEED IN UNCERTAINTY. DO NOT SCALE THIS DRAWING.

DATE	REVISION	PROJECT NORTH
18 NOVEMBER 2014	SPRINKLER ADD IN SHARPS ROOM	 NORTH  PROJECT NORTH
17 DECEMBER 2014	ISSUED FOR CONSTRUCTION	
05 FEBRUARY 2015	VACCINE FRIDGE ROOM CHANGES MADE	
25 FEBRUARY 2015	PUBLIC WASHROOM CHANGES MADE	

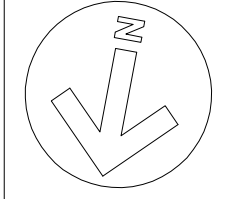
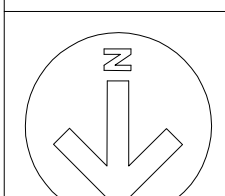
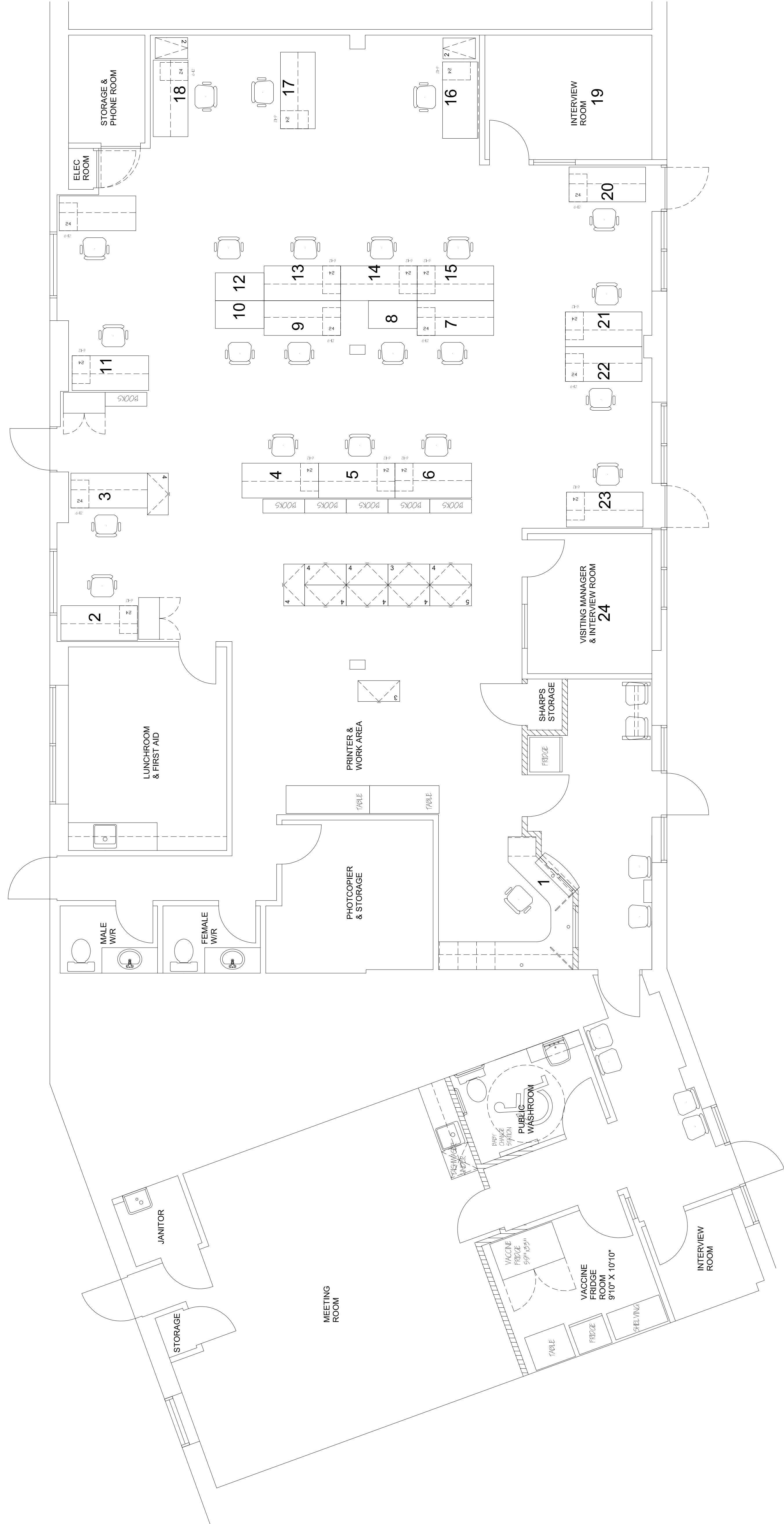

SPENCE & ASSOCIATES
 Design Consultants
 88 Forest Street
 Guelph Ontario
 N1G 1H9
 519 836 3160

LAYOUT PLAN
 SIMCOE MUSKOKA DISTRICT HEALTH UNIT
 For 2 - 25 KING STREET SOUTH
 COOKSTOWN ONTARIO L0L 1L0

Scale	Plot Date
1/4"=10'0"	13-11-14
Drawn	Print Date
G.W.S.	
Checked	Plot No.
	2014-6

C4