

THIS DRAWING IS THE PROPERTY OF SPENCE & ASSOCIATES DESIGN CONSULTANTS AND IS NOT TO BE REPRODUCED WITHOUT PERMISSION. PLEASE VERIFY ALL DIMENSIONS AND REPORT ANY DISCREPANCIES TO THE DESIGNER BEFORE PROCEEDING WITH THE WORK. THIS DRAWING IS FOR INFORMATION ONLY. UNDER NO CIRCUMSTANCES SHALL THE CONTRACTOR PROCEED IN UNCERTAINTY. DO NOT SCALE THIS DRAWING.

DATE	REVISION
14 MAY 2014	DESIGN FOR TENDER AND PERMIT
14 AUGUST 2014	ACCENT WALL PAINT COLOUR ADDED

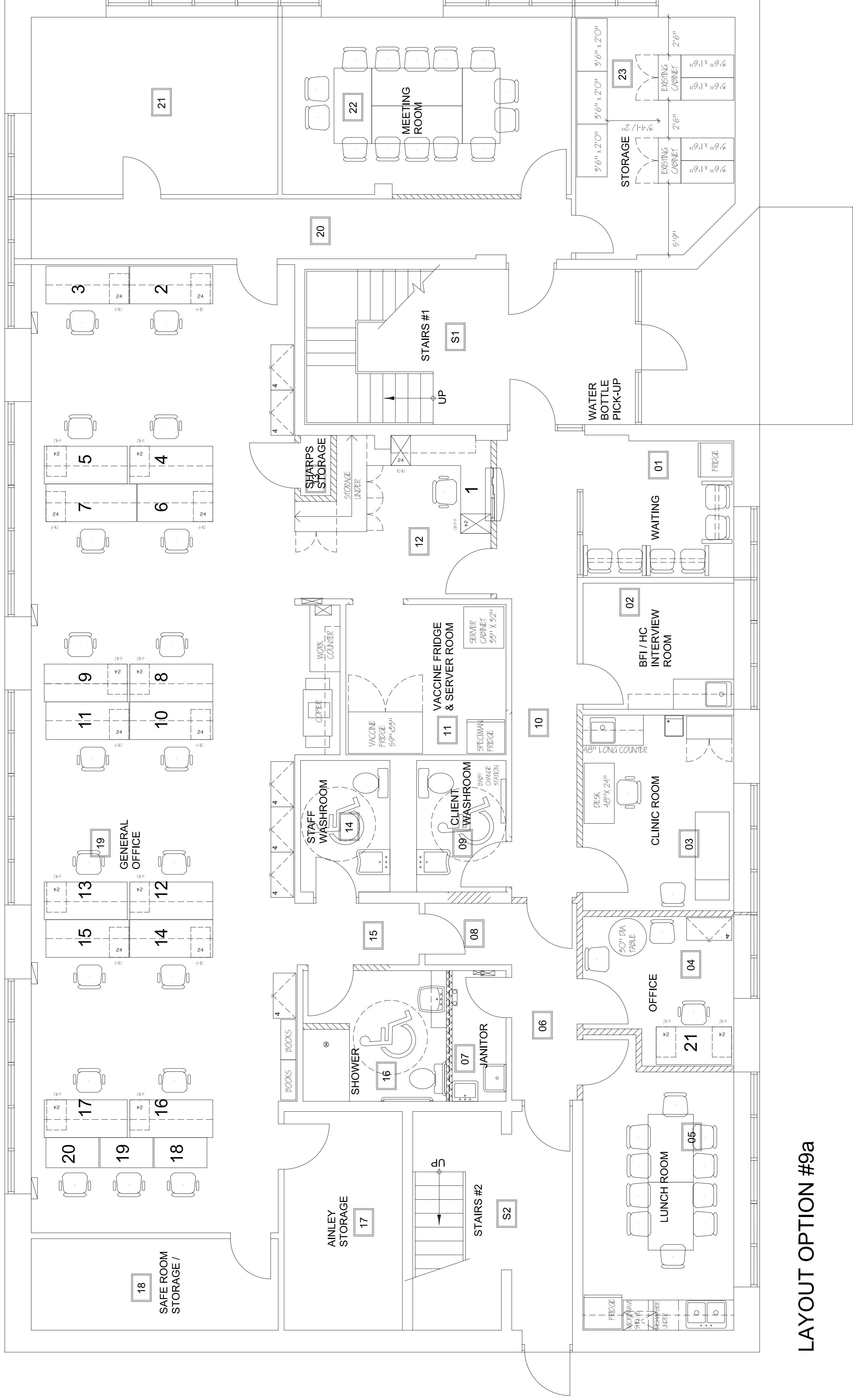

LAYOUT OPTION #9a

SPENCE & ASSOCIATES
 Design Consultants
 88 Forest Street
 Guelph Ontario
 N1G 1H9
 519 836 3160

Title: LAYOUT PLAN OPTION #9A
 SIMCOE MUSKOKA DISTRICT HEALTH UNIT

For: 280 PRETTY RIVER PARKWAY
 COLLINGWOOD ONTARIO

Scale:	1/4"=10'	File Date:	09-04-14
Drawn:	AMS	Print Date:	
Checked:		Sheet No.:	
Job No.:	2012-15		

P7